

SUPERWINCH

SI-SERIES 15000 lb (6804 kg)

PLANETARY HYDRAULIC WINCH
1ST LAYER 15000 Lbs (66.7kN) LINE PULL
INDUSTRIAL SAE J706
HYDRAULIC LOAD CONTROLLED BRAKE
PNEUMATIC OR MANUAL FREESPOOL
MULTI POSITION OPTION FOR FREE SPOOL
HIGH GAUGE STEEL FABRICATED DRUM
SUITABLE FOR STEEL OR SYNTHETIC ROPE
ASSEMBLED IN THE USA

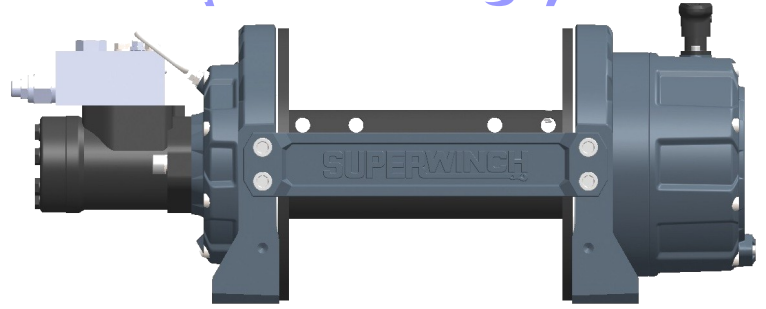

22.5 DEGREES OF ROTATION



SI-15 SAE-J706 Specifications

Pressure at rated pull	2100 psi (144.8 Bar)
Flow (maximum)	15 GPM (57 L p/m)
Lubrication (gearbox)	Synthetic Grease
Compliance	SAE J706
Gearbox	2 Stage Planetary 24:01
Motor	125 cc Hyd Gear Motor
Brake (hydraulic release)	Spring applied multi disk
Load Block Valve	Bidirectional Brake Control
Free spool	Manual or Pneumatic
Drum	W 256.5 mm x Ø 101 mm
Weight (boxed shipping)	79 kg (no rope)
Wire rope (recommended)	1/2" (12.7mm)
Rope Length	45 metre (maximum)

Line Speed Per Layer 15 G p/m (57 L p/min)

Layer 1	7.6 M p/m (25 ft p/m)
Layer 2	9.4 M p/m (31 ft p/m)
Layer 3	11 M p/m (36 ft p/m)
Layer 4	12.7 M p/m (42 ft p/m)
Layer 5	14.3 M p/m (47 ft p/m)

Line Pull Per Layer 15 G p/min (57 L p/min 2100 psi. 144.8 Bar)

Layer 1	15000 lb (66.7 kN)
Layer 2	12273 lb (54.6 kN)
Layer 3	10385 lb (46.2 kN)
Layer 4	9000 lb (40.0 kN)
Layer 5	7941 lb (35.3 kN)

